



Project: \_\_\_\_\_  
 Location: \_\_\_\_\_  
 Cat. #: \_\_\_\_\_  
 Type: \_\_\_\_\_  
 Quantity: \_\_\_\_\_

LED

## DLL 3.5 | 3.5" LED Down Light

### Features:

- High performance LED technology
- Dimmable to 5% with most dimmers
- Compatible with most 3.5" housings
- 90+ CRI - meets Title 24, 2016 requirements

### Applications:

Suitable for most commercial, industrial and institutional applications

- Retail
- Hospitality
- Office
- Residential

### Predicted L70 Lifetime:

- 50,000 hrs (reported)  
 (based on LM-80, TM-21 and in-situ laboratory testing)

### Ambient Operating Temp:

- -30°C to 40°C

### Construction:

- White painted diecast housing/trim ring
- E26 medium screw-base Edison connector allows for easy retrofit of incandescent housings
- Adjustable torsion spring for quick toolless installation designed to fit 3.5" housings automatically without changing mounting tab

### Certifications:

- cULus Listed for damp and wet locations (*not suitable for coastal/salt water areas*)
- RoHS compliant
- Meets State of California Title 24, 2016 requirements



### Warranty:

- 5 year limited system warranty - see [www.LumenFocus.com](http://www.LumenFocus.com) for complete warranty terms and conditions



## Ordering Guide:

example: DLL 3.5 MD 12 WBSQ 830

Series	Size	Output	Voltage	Reflector Trim	CRI/CCT	Frame
DLL	3.5	MD	12		930	
<b>DLL</b>	<b>3.5</b> 3.5"	<b>MD</b> Medium	<b>12</b> 120V	<b>WB</b> White Baffle (Round)  <b>WBSQ</b> White Baffle (Square)	<b>930</b> 90 CRI / 3000K	<b>Blank</b> No Frame  <b>3.5ICNC</b> 3.5" IC New Construction Frame-In Kit  <b>3.5ICRM</b> 3.5" IC Remodeler Frame-In Kit

## Schematic:

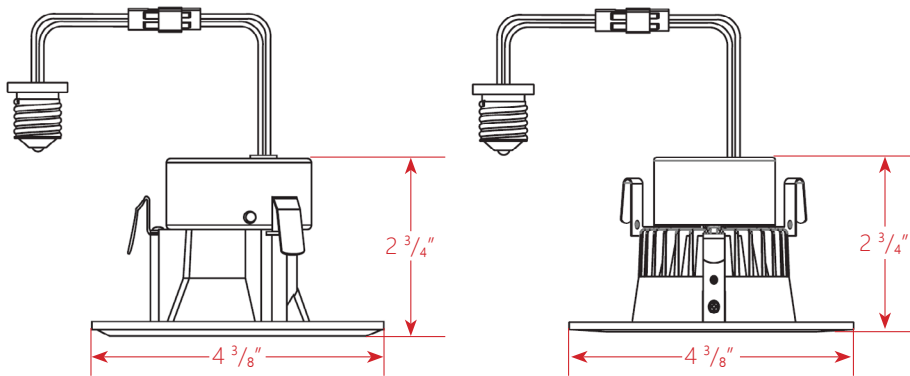

## Photometric Data:

### DLL 3.5 MD 12 WB 930

Test No.: STC20151116

Luminaire Lumens: 564 lm

Luminaire Watts: 8.6W

Efficacy: 65.6 LPW

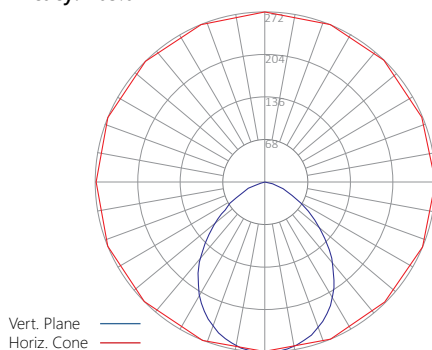

## Frame-In Kits:

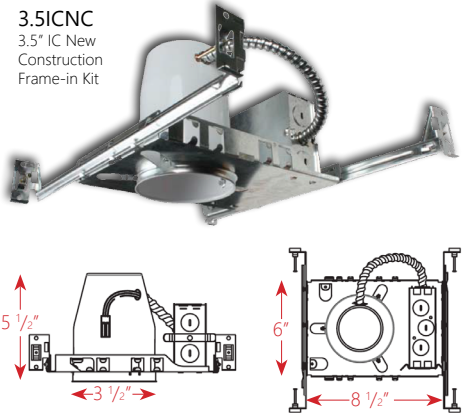

### New Construction Applications: 3.5ICNC

Designed for new construction applications and in ceilings with direct contact with insulation. Air tight construction provides reduced energy costs.

- CULUS Listed for damp locations
- Galvanized steel construction with removeable housing for easy access to the junction box
- Pre-installed Real nail easily installs in regular and engineered lumber
- Adjustable bar hangers from 13 3/8" - 25" and can be repositioned 90° on plaster frame
- Contains one 1 1/8", six 7/8" knockouts and four Romex pryouts with strain relief

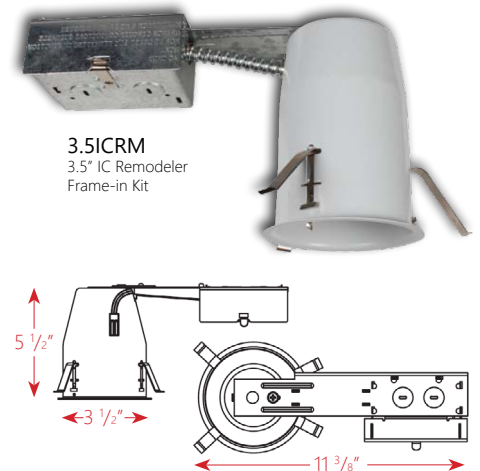

### Remodel Applications: 3.5ICRM

Designed for remodel applications and in ceilings with direct contact with insulation. Air tight construction provides reduced energy costs.

- CULUS Listed for damp locations
- Galvanized steel construction with removeable housing for easy access to the junction box
- Four remodel clips secure housing and accommodates 1/2" and 5/8" ceiling materials
- Contains one 1 1/8", six 7/8" knockouts and four Romex pryouts with strain relief

